



Sloki Software Technologies LLP

www.sloki.in

ISO 9001:2015 Certified

**Product Brochure on SBUSCAN
CAN Bus Analyzer and Monitoring Device**



SBUSCAN (Gallery)

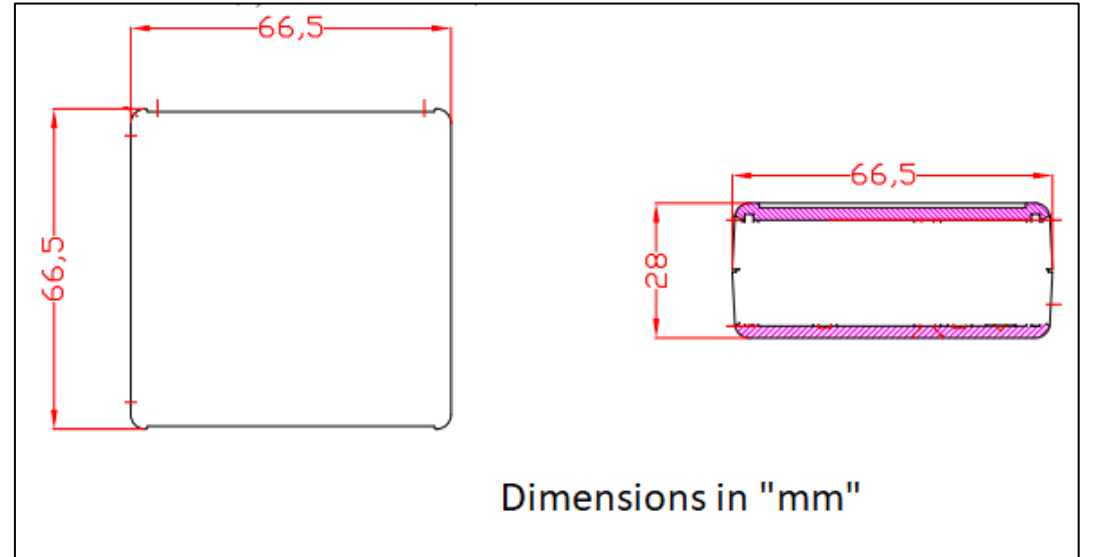

Benefits & Applications

- Supports CAN 2.0B standard – Standard and Extended frames.
- Windows based tool to Monitor, Analyze and Simulate CAN node.
- Several Windows based in-house tools are developed on for this hardware, such as SAE J1939 simulator, OBD2 simulator, SAE J1939 Flash programming tool, UDS Flash programming tool.
- Support for Linux Operating System with SAE J2534 Interface Protocol Layer.

Applications:

- Automotive/ECU software development companies
- Industrial companies– working on CAN based applications

Features

- Real time CAN bus monitoring with time stamp accuracy of 1ms (Either Tx or Rx).
- Windows device driver library (DLL) support for custom application development.
- Support for Windows platform VC++, C# .NET based API exposure for seamless integration.
- Detailed API documentation for custom tool development.
- Complete integration with GUI tool - BUS MASTER.
- Supported on WINDOWS and LINUX OS.
- Supported with Libraries for C, C# .NET and PYTHON.

Costing and Lead Time Details:

Sl #	Quantity	Unit price (INR) (exlc. GST)	Lead time
1	1-4	10,000.00	1 week
2	5-9	9,500.00	2 weeks
3	10-49	8,000.00	4 weeks
4	50-99	6,000.00	4 weeks
5	100-499	5,000.00	6 weeks
6	500-999	4,000.00	8 weeks
7	1000+	3,500.00	8 weeks

Registered / Billing Address:

Sloki Software Technologies LLP,
D317, Sumadhura Sandoval, Thubarahalli,
Varthur Road,
Bangalore – 560066.

Correspondence / R&D Centre:

Sloki Software Technologies LLP,
#166, 5th Main, M C Layout, Opp. BDA Complex,
Vijayanagar - 560040.
INDIA,

Website: <http://sloki.in/> ,

Ph.: +91-9880-667-877.